

Background

Consultation 1- July/August 2019

rivingtonstreetstudio



Aerial view of site  
(courtesy of bing maps)

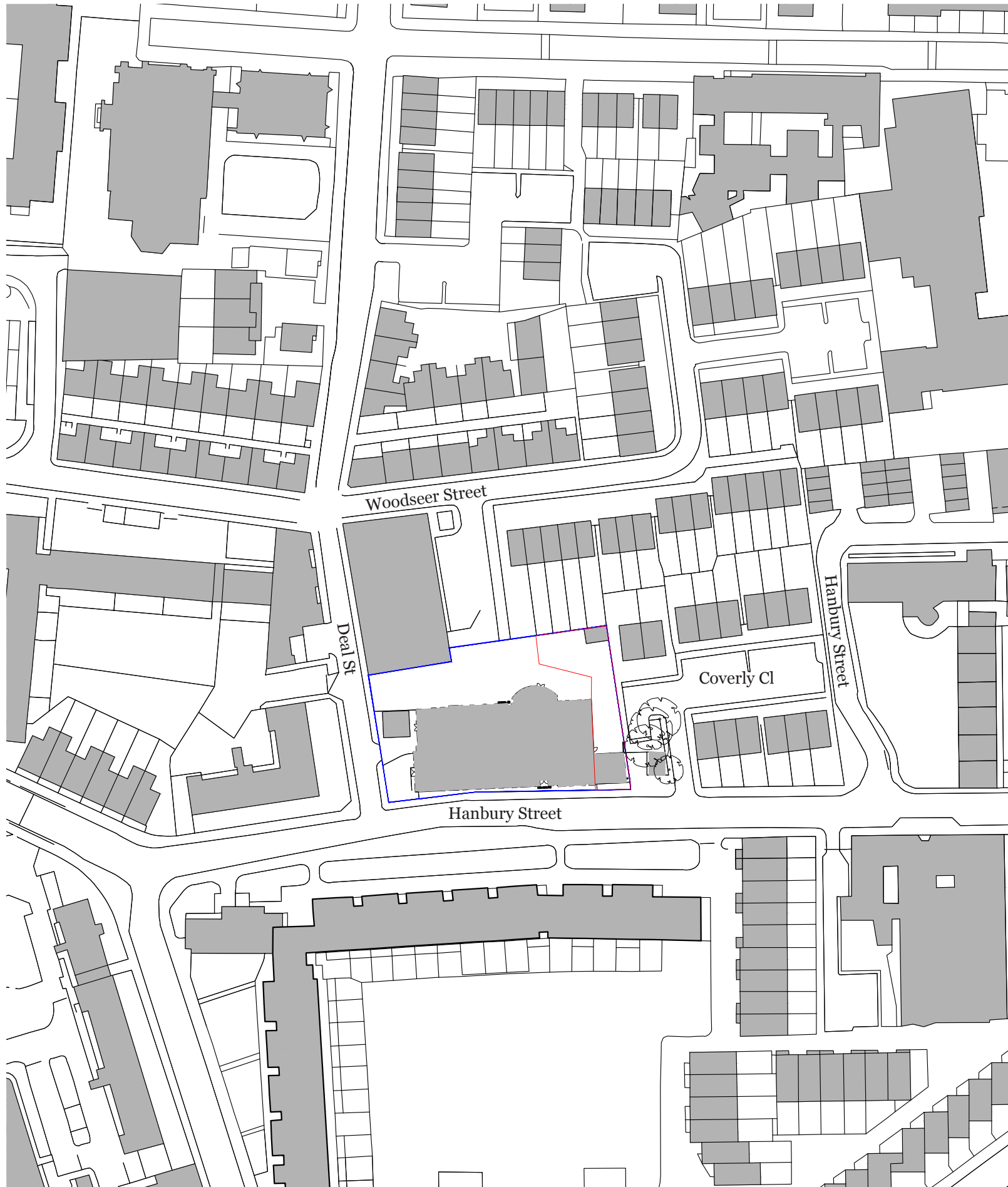

Why do we need to build?

Tower Hamlets has more than 19,000 people registered in need of housing, with 10,000 of those in acute need. Private sector rents are 3 times as much as social rents, not covered by Housing Benefit and out of reach for families on low incomes. Families needing a 2-bedroom home can wait for up to 12 years.

Why are we consulting?

We are consulting with local residents to help establish the brief and discuss possible proposals for the project. We want to hear about your views, experiences, like and dislikes as well as any interesting history you may know to give us a clear picture moving forward.

Who are we?

Rivington Street Studio is a RIBA chartered architecture practice based in Bromley-by-Bow. We have been designing housing and education projects in east London for 20 years, and currently have over a dozen projects in progress in Tower Hamlets. We have been appointed by The London Borough of Tower Hamlets to develop a design for affordable housing on this site.

Rivington Street Studio- precedent projects



Kenninghall Road, Hackney- Planning



Lowder House, Wapping - Planning approved



Pier Street Housing - Built



Grafton Quarter - Built





View looking towards the Montefiore Centre



View looking towards the rear of Montefiore Centre



View from Montefiore Centre roof



View looking towards the Montefiore Housing extension



View down Hanbury Street



View from Montefiore Centre parking



Option 1 - New Build

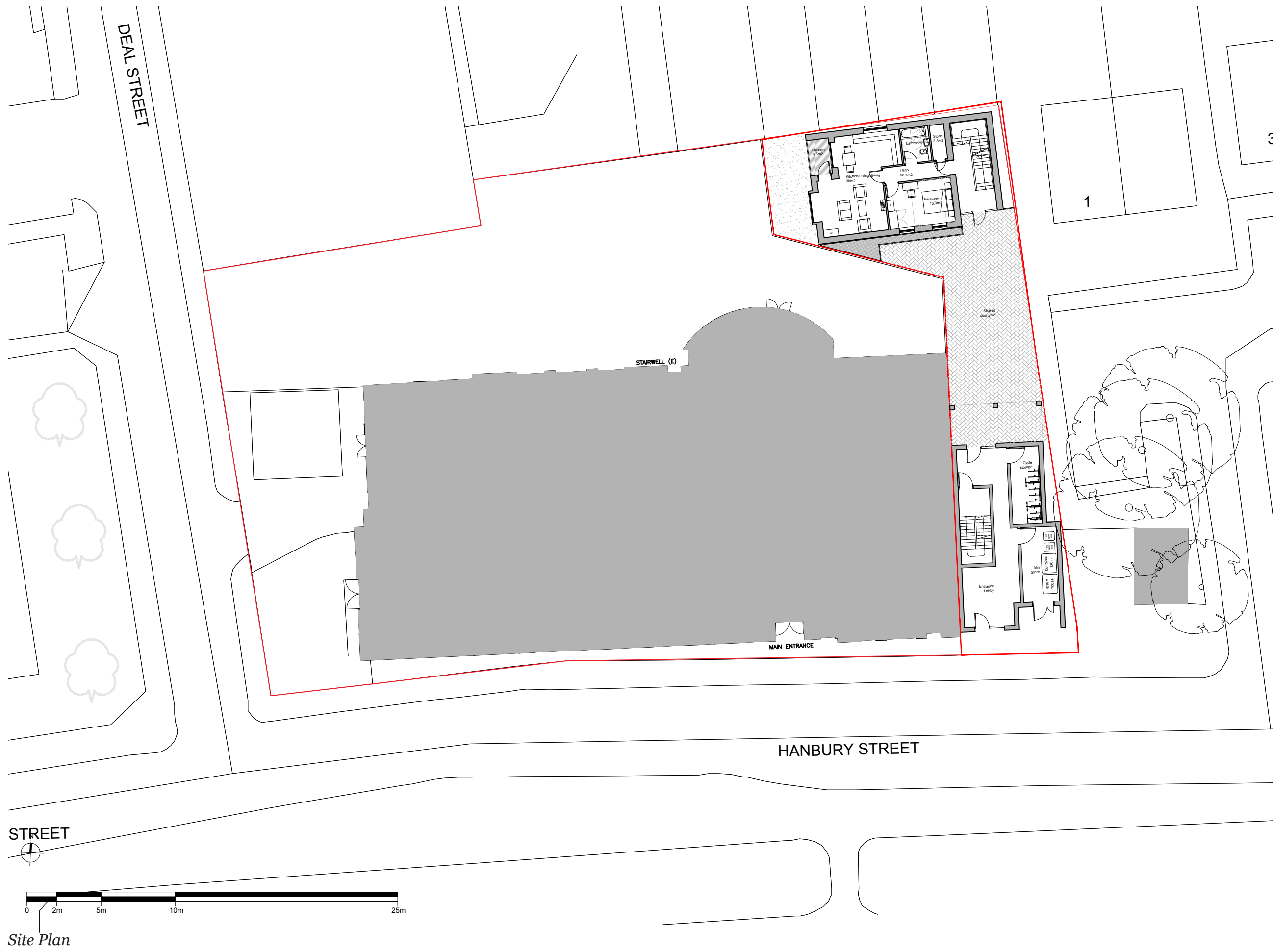

Site Plan



Proposed Elevation - New Build

Consultation 1- July/August 2019



Building 1 L01-L03 Floor Plan



Building 2 L00-L02 Floor Plan

Option 1  
Option 1 proposes a total demolition of the existing building and rebuilding. Building 1 will have 4 x 2-beds and Building 2 will have 3 x 1-beds.



Building 1 CGI visual



Option 2 - New Build with retained facade

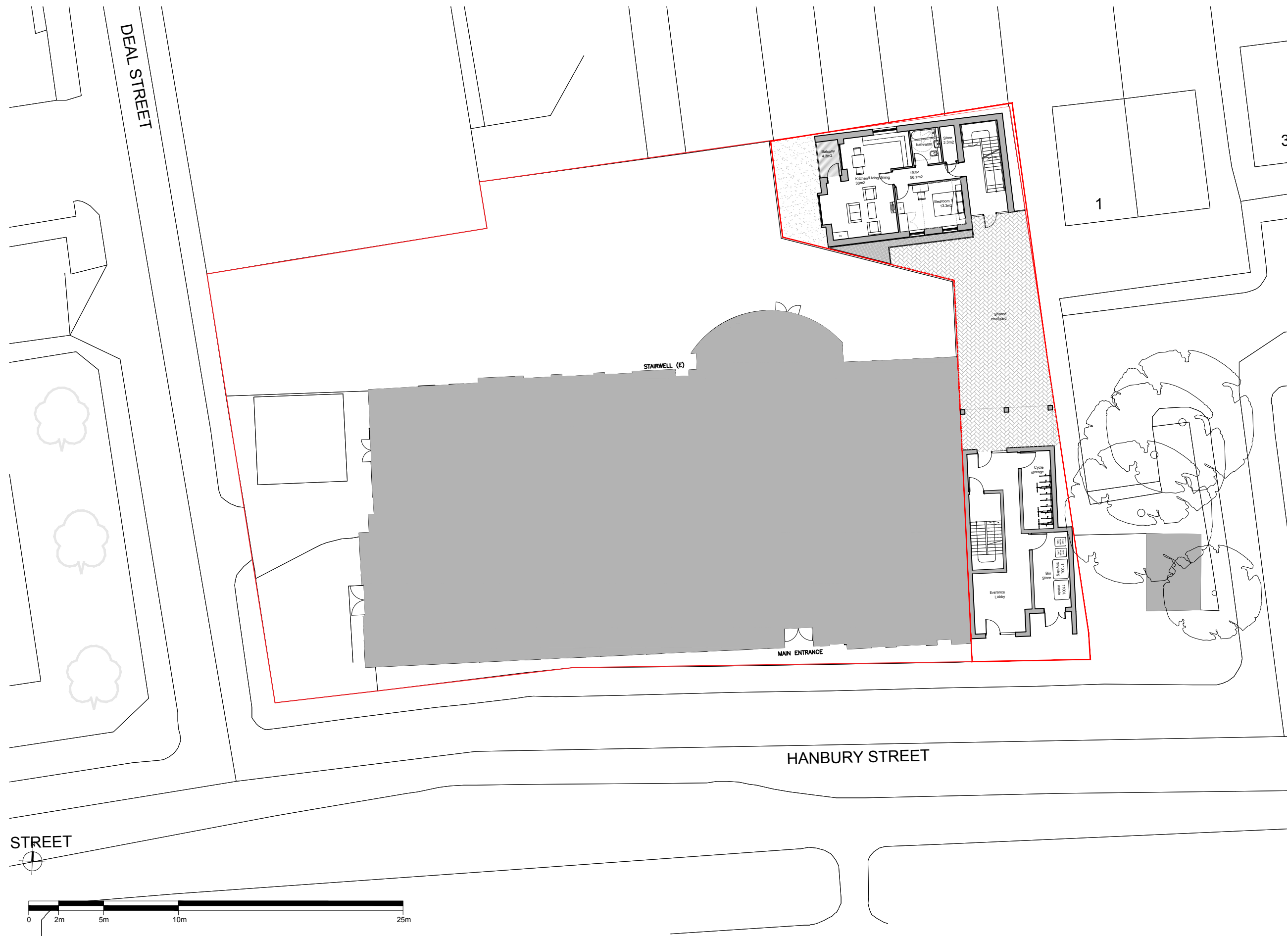

Site Plan



Proposed Elevation - New Build

Consultation 1- July/August 2019



Building 1 L01-L03 Floor Plan



Building 2 L00-L02 Floor Plan

Option 2

Option 2 proposes the retention of the existing facade. This aims to maintain the heritage value of the Montefiore Centre. Building 1 will have 3 x 2-beds and building 2 will have 3 x 1-beds.



Building 1 CGI visual